

PRECAST CONCRETE PIPE CULVERT WITH REBATED JOINT - CLASS X

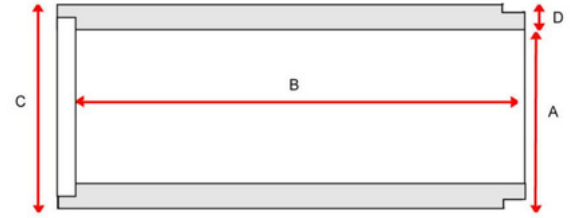

STANDARD DIMENSION

	Nominal Diameter		Length B mm	A mm	C mm	D mm	Approx. Weight mt
	mm	in					
1" X 5"	300	12	1520	340	360	20	0.11
1 ¼" X 5"	375	15	1520	375	445	35	0.15
1 ½" X 5"	450	18	1520	450	530	40	0.24
2" X 5"	600	24	1520	600	700	50	0.4
2 ½" X 5"	750	30	1520	750	860	55	0.55
3" X 5"	900	36	1520	900	1030	65	0.78
4" X 5"	1200	48	1520	1200	1370	85	1.35
5" X 5"	1500	60	1520	1500	1710	105	2.08

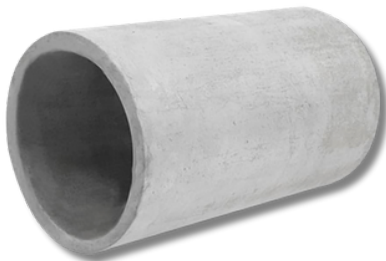

PRECAST CONCRETE PIPE CULVERT WITHOUT JOINT - TYPE S

STANDARD DIMENSION

	Nominal Diameter		Length B mm	A mm	C mm	D mm	Approx. Weight mt
	mm	in					
1" X 5"	300	12	1520	300	370	35	0.13
1 ¼" X 5"	375	15	1520	375	445	35	0.16
1 ½" X 5"	450	18	1520	450	530	40	0.23
2" X 5"	600	24	1520	600	700	50	0.33
2 ½" X 5"	750	30	1520	750	860	55	0.43
3" X 5"	900	36	1520	900	1020	60	0.57
4" X 5"	1200	48	1520	1200	1350	75	1.00
5" X 5"	1500	60	1520	1500	1670	85	1.35

Constituent Materials

Cement	MX 522 Ordinary Portland Cement
Steel Reinforcement	BS 449 / MS 146
Aggregates	BS 882 / MS 29 Mining Sand / 20mm Aggregates
Admixture	BS 5075 / MS 922 Super Plasticizer
Cold Drawn Wire	BS 4482 / MS 144 Lateral Reinforcement Stirrup
Mild Steel Plate	BS EN 10137-1 End Plate (Grade 43A)

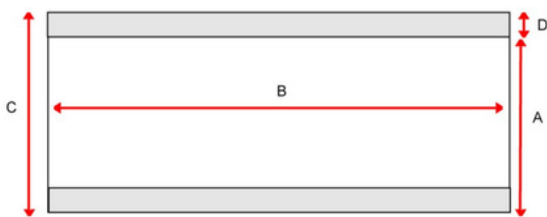

*The above measurements are based on standard measuring methods. Actual sizes may vary slightly.
*Our company reserves the right to modify the above sizes without prior notice.

